

WARRANTY INFORMATION

At Chimera, we stand behind our Lightbanks, Speed Rings, and light control accessories with a limited 5-year warranty against manufacturing defects in materials, workmanship, and color stability. If our products are not fully operational out of the box or if they fail to perform within five years from the date of purchase, return for repair or replacement at no charge. Of course, Chimera's warranty cannot cover damage caused by accidents, improper care or use, or the natural deterioration of materials over an extended period of time. This warranty does not apply to expendables, such as light bulbs, and certain OEM products.

TIPS FOR CARE AND USE

Cleaning - Your Chimera Lightbank can be cleaned by hand washing with cold water, a sponge and mild soap. Do not machine wash. To dry, assemble the Lightbank onto a Speed Ring and completely air dry.

Repair - Chimera has an expert in-house repair department. Lightbanks need to be clean, with any added tape removed before sending in for repair. If the Lightbank is received in dirty or in taped condition, the repair may be refused and returned to the sender. Please call in advance to get a Return Authorization Number and repair estimate at +1.888.444.1812 or +1.303.444.8000.

RECOMMENDED BEST PRACTICES FOR CLEANING AND DISINFECTING CHIMERA LIGHTBANKS & TEXTILES



DO NOT USE HARSH CLEANERS LIKE BLEACH OR OTHER CHLORINATED PRODUCTS ON ANY TEXTILE FROM CHIMERA

DO NOT MACHINE WASH OR DRY ANY TEXTILE FROM CHIMERA

Fabric Diffusions:

All diffusions should only be cleaned and disinfected by hand. **DO NOT MACHINE WASH OR DRY!** Use mild soap (something like Dawn) and hand wash thoroughly in warm water. Air dry.

Lightbanks and Items with Laminated Textiles i.e., Black + Reflection:

Thoroughly wet a clean cloth using a solution of warm water with mild soap. Wipe each surface completely with the soap solution and then repeat with a clean, wet cloth to rinse. Air dry. Alcohol-based aerosol spray with at least 70% alcohol can be effective for both sides of the textiles. Spray evenly to coat all surfaces, use a clean cloth to reach hard to spray areas. Air dry.

Rings & Frames:

Wipe all surfaces clean with at least 70% alcohol solution and allow to air dry.



INSTRUCTIONS FOR CARE AND USE

1860 - 1874

PANCAKE LANTERN



ASSEMBLY

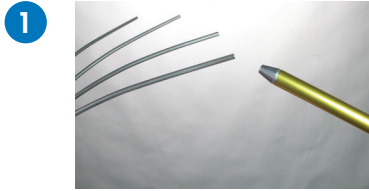

Slide tube sections of poles over ferrules.



Suspend the poles by the metal ring to allow them to fall into order.

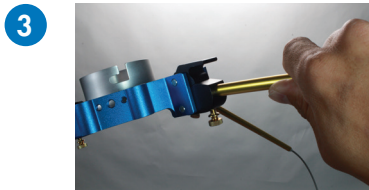

Insert one pole into Speed Ring.
NOTE: The appearance of your Speed Ring may be different than shown.

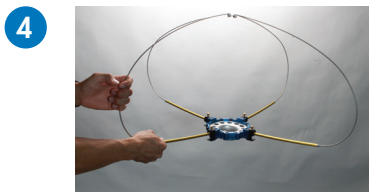

Insert the remaining poles in order around the Speed Ring.



Place the lantern on the frame and open all 4 zippers on top of the Lantern body. Turn the Speed Ring vertically with one pole pointed up. Align one of the corner seams in the Lantern body with the upward-facing pole.



Pull the body over the pole until the curve in the pole fits in the curve in the body. Close the zippers on top of the body and attach the assembled Lantern to the light fixture.

MOUNT THE SKIRTS (Optional)

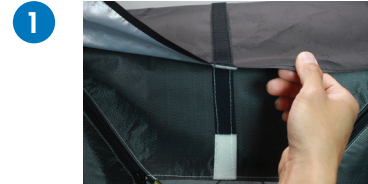

Unzip one of the corners on the skirt from top to bottom. Wrap the skirt around the lantern, making sure the corners are aligned.



Align the hook-and-loop strips on the skirt with the hook-and-loop strips on the Lantern. Zip up the zipper.



Adjust the skirt as desired by unzipping the corner zippers from bottom to top and rolling up the sides.

WARNING

FAILURE TO FOLLOW THESE SAFETY PRECAUTIONS COULD CREATE A HAZARDOUS CONDITION

- » This product is NOT intended for household use.
- » This product is intended for use with bare bulb fixtures pointed straight down.
- » Refer to the fixture manufacturer's recommendations before operating the light in this position.
- » Do not leave unattended.
- » Use the light's protective screen or shield at all times.
- » Use in a moderate temperature environment.
- » Open the Lantern's flaps for ventilation as required.
- » Maximum lamp rating for Small Lantern (1860, 1864) is 400 watts.
- » Maximum lamp rating for Medium Lantern (1865, 1869) is 1500 watts.
- » Maximum lamp rating for Large Lantern (1870, 1874) is 2,000 watts.

DISASSEMBLY AND STORAGE

Removing the Lantern from the Speed Ring - follow the steps above in reverse order. When using a Chimera Quick Release Ring, simply release the locking levers to release the pole tension and then slide the poles from the mounting holes.

Leave the poles in the Lantern if desired. It is optional to remove the optional diffusion baffle and the front screen. Crease the short sides of the Lantern and flatten. Fold the Lantern in half once, then roll up and place it into the storage sack. Always make sure your Lantern is clean and completely dry before storing.